

# CONROE POLICE DEPARTMENT



The City of Conroe was named the fastest-growing city in the country among cities with more than 50,000 residents according to the latest U.S. Census Bureau and is conveniently located forty miles north of downtown Houston in Montgomery County, Texas. The department has an authorized sworn force of 132 officers to represent the progressive and proactive agency located within one of the top 10 fastest growing cities in the state. Due to this explosive growth, there are great opportunities for advancement or transfer to various specialized units.

The City of Conroe is a great place to raise a family with affordable homes and three exceptional school districts within its jurisdiction. The City of Conroe borders the 22,000 acre recreational Lake Conroe, has 26 city parks, and has numerous public and private golf courses. The city sponsors annual festivals and is home to two historic downtown theatres. Nationally recognized medical facilities are located in the region with a Level 2 Trauma Center certification within the Conroe Medical Center.

TMRS Retirement 7% with 2-1 Match, Group Life & AD&D, Health/Dental/Vision, Longevity Pay, 3 Week Vacation/12 Holidays/Sick & Comp Accrual, Standard 8 Hour Shifts / 12 Hour Static Shifts / 12 Hour Rotating Shifts, Take Home Vehicle Program, Uniforms and Equipment Provided.

All applicants will be subjected to Written and Physical Fitness Exams, Background, Polygraph, Oral Review Board, Psychological, Medical and Drug Screening and the applicant must meet all current requirements of Texas Government Code Chapter 143 – Civil Service Rules, TCOLE certification requirements, and hiring standards of the City of Conroe.

# CONROE POLICE DEPARTMENT

## ENTRY EXAM PROCESS

### APPLYING

Complete a Letter of Intent and submit it to the Conroe Human Resources Department 7 calendar days prior to the posted current exam date.

### REGISTRATION

At the entry exam, Applicants will be required to:

- present a valid form of U.S. Government and/or State issued identification
- submit a signed copy of the "Release of Liability" at test day registration
- submit a completed "Applicant Data" form
- applicants with prior military service will be required to bring the original and one copy of their DD-214.

### TESTING

**APPLICANTS ARRIVING LATE WILL NOT BE ALLOWED TO TAKE ANY PART OF THE ENTRY-LEVEL EXAM.**

The written exam will be administered prior to the physical agility test. The physical agility test must be attempted the same day as the written exam. The schedule of events will be as follows:

- Applicant registration
- Introduction, welcome and explanation of testing
- Exam instructions
- Written exam
- Scoring of exams
- Information and instructions on application for employment and hiring process
- Explanation of background investigation process
- Question and answer
- Those that are successful on the written exam will relocate to the CPD/FBI Training Facility
- Physical Agility Test

Applicants who successfully complete and pass all phases of the testing, interview, and background investigation will be hired based on the current eligibility list. Applicants not meeting employment requirements will receive a formal letter of rejection. Applicants receiving this letter are encouraged to reapply at our next entry exam opportunity.



## CONROE POLICE DEPARTMENT PHYSICAL AGILITY TEST

RUN 1 ½ MILE – TIME LIMIT – 16.30 MIN/SEC

OBSTACLE COURSE -TIME LIMIT – TWO MINUTES

1. The applicant will sit in the driver's seat of a marked patrol unit and close the door.
2. The applicant's time will begin when the trunk release inside the passenger area of the patrol vehicle is depressed, thereby opening the trunk of the vehicle.
3. The applicant will exit the patrol vehicle, proceed to the trunk of the vehicle, remove the spare tire, and place it on the ground directly behind the patrol vehicle.
4. The applicant will then run 50' to the back door of the two story training building and, upon entering the building, will enter the first room to the left and ascend a flight of stairs.
5. At the top of the stairs, the applicant will enter the doorway to the right and proceed down the hallway to a second flight of stairs.
6. The applicant will descend the stairs until reaching the lower level of the training building.
7. The applicant will exit the stairwell to the right and proceed down the hallway to the front door of the training building.
8. The applicant will exit the building through the front door and run 150' to the 6' wooden fence, which the applicant will be required to negotiate by going over the top of it.
9. After negotiating the 6' fence, the applicant will exit to the left and run 60' to the next obstacle, a 5' window, which the applicant will climb through.
10. After clearing the 5' window, the applicant will perform a balance walk on a set of three telephone poles. If the applicant falls off of one of the poles while performing the task, they must start the balance walk from the beginning.
11. Upon completing the balance walk, the applicant will proceed to an 8' chain link fence and negotiate it by going over the top of it.
12. When the applicant clears the 8' chain link fence they will move to the 165 pound mannequin, which will be lying on the ground next to the chain link fence.
13. The applicant will be required to drag the mannequin 25' to the roadway.
14. The applicant's time stops when the mannequin has been drug 25'to the roadway.

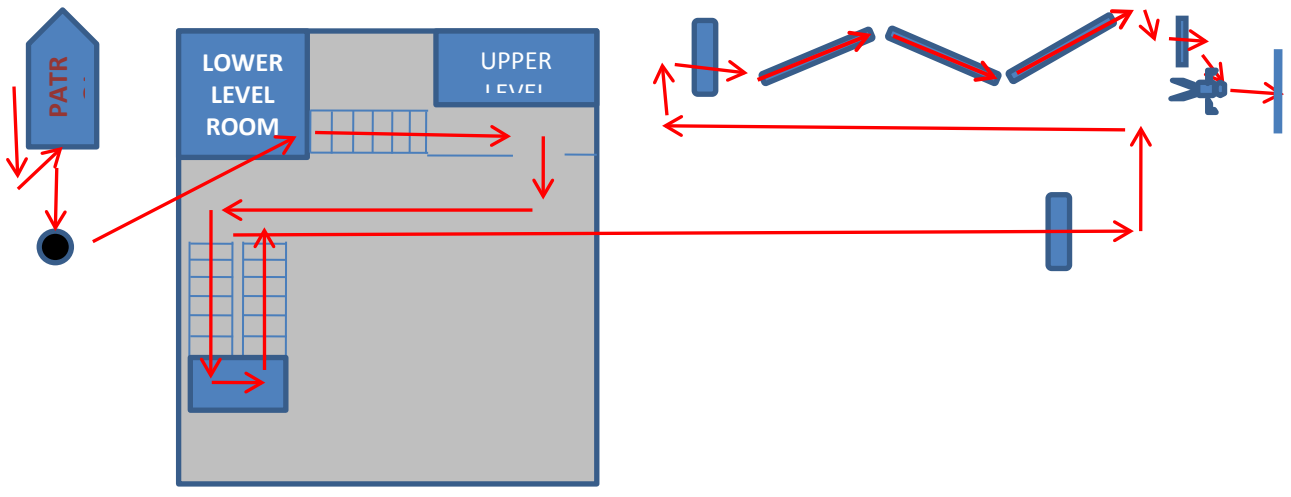

## Directions to Conroe Police/FBI Training Facility 2300 Sgt. Ed Holcomb Blvd.

From IH-45, proceed west on South Loop 336 West. Go 1.5 miles to the red light intersection of Sgt. Ed Holcomb Blvd. Turn south onto Sgt. Ed Holcomb Blvd. and go 7/10 mile to access road and turn right (west). Travel 3/10 mile to entrance gate for CPD/FBI Firearms Training Facility.

