

RECEIVED

OCT 12 2012

CITY OF CONROE
CITY SECRETARY

mjp

NOTICE OF PUBLIC HEARINGS ON SH 105 WEST ANNEXATIONS
BY THE CITY OF CONROE

The City Council of the City of Conroe, Texas will conduct two public hearings to receive public comment on the proposed three year plan annexation of the following described territory to be incorporated within the boundaries of the City of Conroe:

Annexation Parcel No. 2014-02, 1,295 acres of land, more or less, out of the William C. Clark Survey (A-0006), William Atkins Survey (A-0003), James Smith Survey (A-0037) and John T. Vince Survey (A-0041) in Montgomery County, Texas, said territory being located in the general vicinity north/northwest of the intersection of State Highway 105 West and Tejas Boulevard and including Montgomery County Utility Districts (MUDs) 3 and 4 and the April Sound Subdivision.

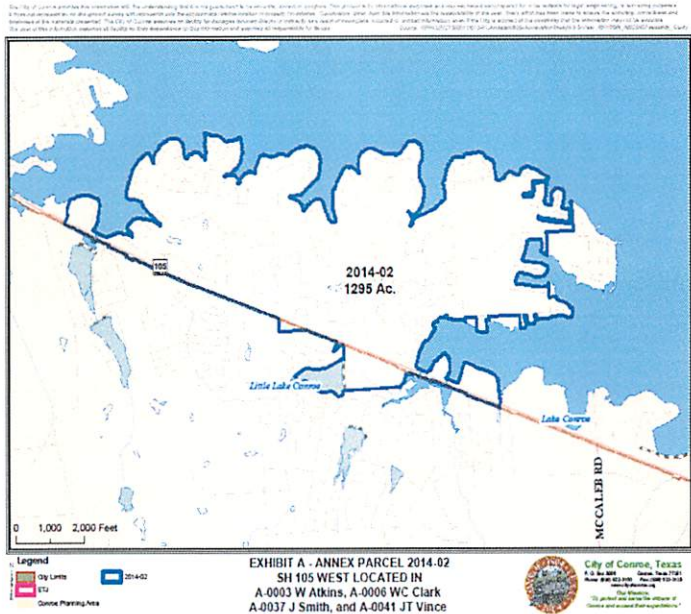

The public hearings will be held at 6:00 p.m. on Monday, October 29, 2012 and at 4:00 p.m. on Tuesday, October 30, 2012 in the City Council Chambers of the Conroe City Hall located at 300 West Davis Street in Conroe, Texas. The public is invited to attend and make comment.

Signed this 17th day of October 2012.

By/s/MARLA J. PORTER, CITY SECRETARY

RECEIVED

OCT 12 2012

CITY OF CONROE
CITY SECRETARY



NOTICE OF PUBLIC HEARINGS ON SH 105 WEST ANNEXATIONS
BY THE CITY OF CONROE

The City Council of the City of Conroe, Texas will conduct two public hearings to receive public comment on the proposed three year plan annexation of the following described territories to be incorporated within the boundaries of the City of Conroe:

Annexation Parcel No. 2014-01, 1,939 acres of land, more or less, out of the John T. Vince Survey (A-0041), J.W. Singleton Survey (A-0496), William C. Clark Survey (A-0006), James Smith Survey (A-0037) and Robert Marsh Survey (A-0355) in Montgomery County, Texas, said territory being located in the general vicinity northwest and southwest of the intersection of State Highway 105 West and Beech Road.

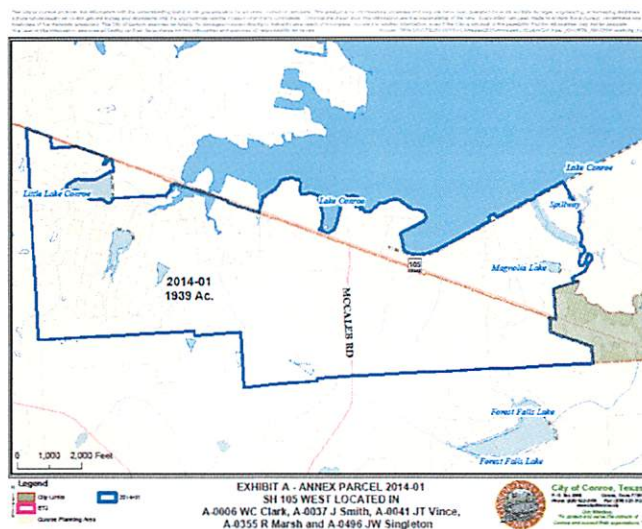

Annexation Parcel No. 2014-03, 63 acres of land, more or less, out of the William C. Clark Survey (A-0006) in Montgomery County, Texas, said territory being located in the general vicinity east of the intersection of Diamondhead Road and Mesa Oak.

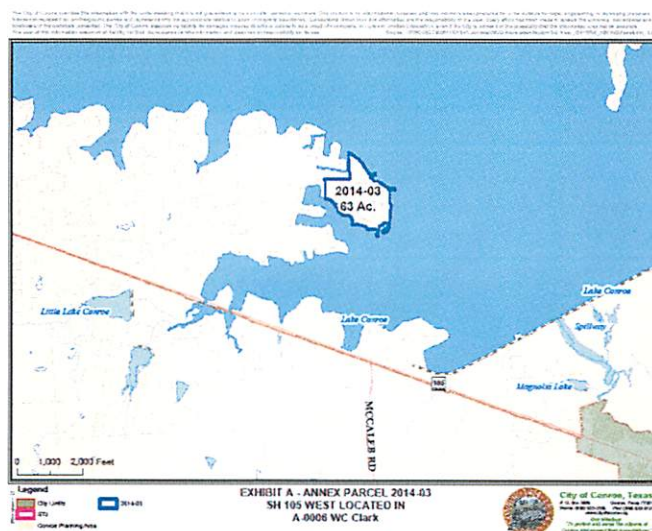

The public hearings will be held at 4:00 p.m. on Monday, October 29, 2012 and at 6:00 p.m. on Tuesday, October 30, 2012 in the City Council Chambers of the Conroe City Hall located at 300 West Davis Street in Conroe, Texas. The public is invited to attend and make comment.

Signed this 17th day of October 2012.

By/s/MARLA J. PORTER, CITY SECRETARY